

C 227-30
Tobias Rudolph

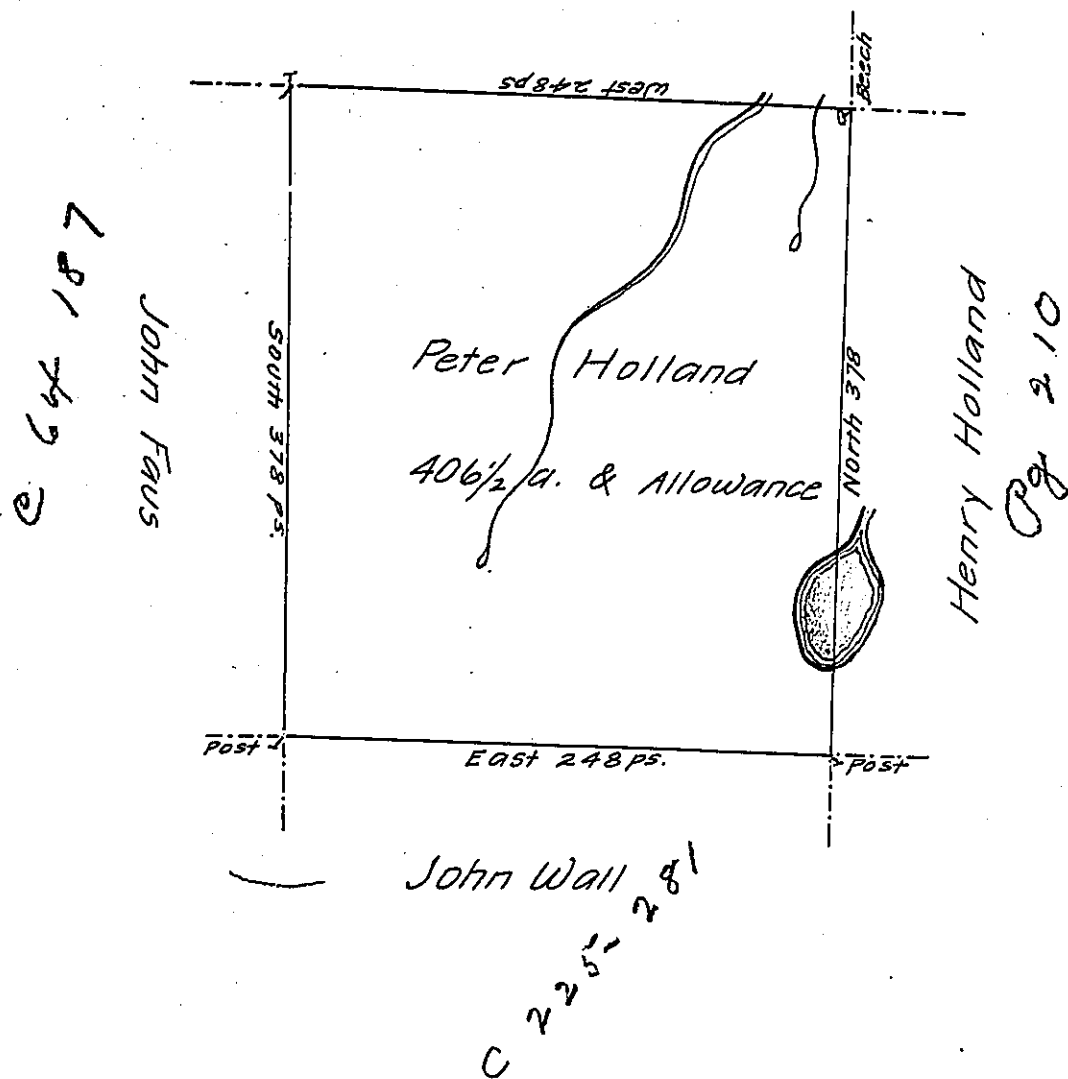

A Draught of a Tract of Land Called _____ Situate on ^{ye} _A
 Waters of Salt Lick Creek Adjoining Land of John Tause, and others,
 in Stoke Township + Northumberland County Survey'd on the 26th
 day of April 1785 for Peter Holland by Virtue of his Warrant dated
 the 4th. day of April 1785 Containing four Hundred and Six Acres
 and 1/2 and allowance of Six p. Cent for Roads &c.

by

To John Lukens Esqr. }
 Surveyor Genl. }

Wm. Gray D.S.
 now Luzerne County

IN TESTIMONY that the above is a copy of the original remaining on file in
 the Department of Internal Affairs of Pennsylvania, made
 conformably to an Act of Assembly approved the 16th day of
 February, 1833, I have hereunto set my Hand and caused
 the Seal of said Department to be affixed at Harrisburg,
 this fifth day of June 1905

James C. P. Pennington
 Secretary of Internal Affairs.